



A PROJECT BY



Vaishnavi

ENCLAVE

Your Dream Destination



Welcome to your
Dream Destination



Vaishnavi ENCLAVE

Welcome To Your Dream Destination - Vaishnavi Enclave. With a strong vision and aspiration of offering quality flats. Vaishnavi Enclave is a residential project which is one of its own kind for providing a small dream world for you with the greatest security and peace of mind. Truly it's a world in itself. In-fact calling it just a world won't do justice; It's your dream world. A fairy tale residential complex where your imagination comes to actuality. Vaishnavi Enclave is meticulously designed and exclusively planned with world class amenities and top line specifications with the finest textures and finishes. The Group is highly known for their commitments, timely completion and quality of the projects.

Booking a property with Vaishnavi Enclave is booking dreamworld for yourself and your family.

Typical Floor Plan (1st to 6th) A & B BLOCK

FLAT NO.	DESCRIPTION	CARPET AREA	BALCONY	BUILD UP AREA	TOTAL S/B. UP AREA
01	3 BHK + 3 Toilet + Servant Room	1050 S.F.	88 S.F.	1190 S.F.	1606 S.F.
02	3 BHK + 2 Toilet	960 S.F.	88 S.F.	1090 S.F.	1471 S.F.
03	3 BHK + 2 Toilet	960 S.F.	88 S.F.	1090 S.F.	1471 S.F.
04	3 BHK + 3 Toilet + Servant Room	1050 S.F.	88 S.F.	1190 S.F.	1606 S.F.



Ground Floor Plan

Isometric View | *The Symbol of Satisfaction*



4 Flat type : 3BHK



1 Flat type : 3BHK



3 Flat type : 3BHK



2 Flat type : 3BHK

Floor Plan A & B Block

Typical First to Sixth Floor Plan

Vaishnavi
ENCLAVE

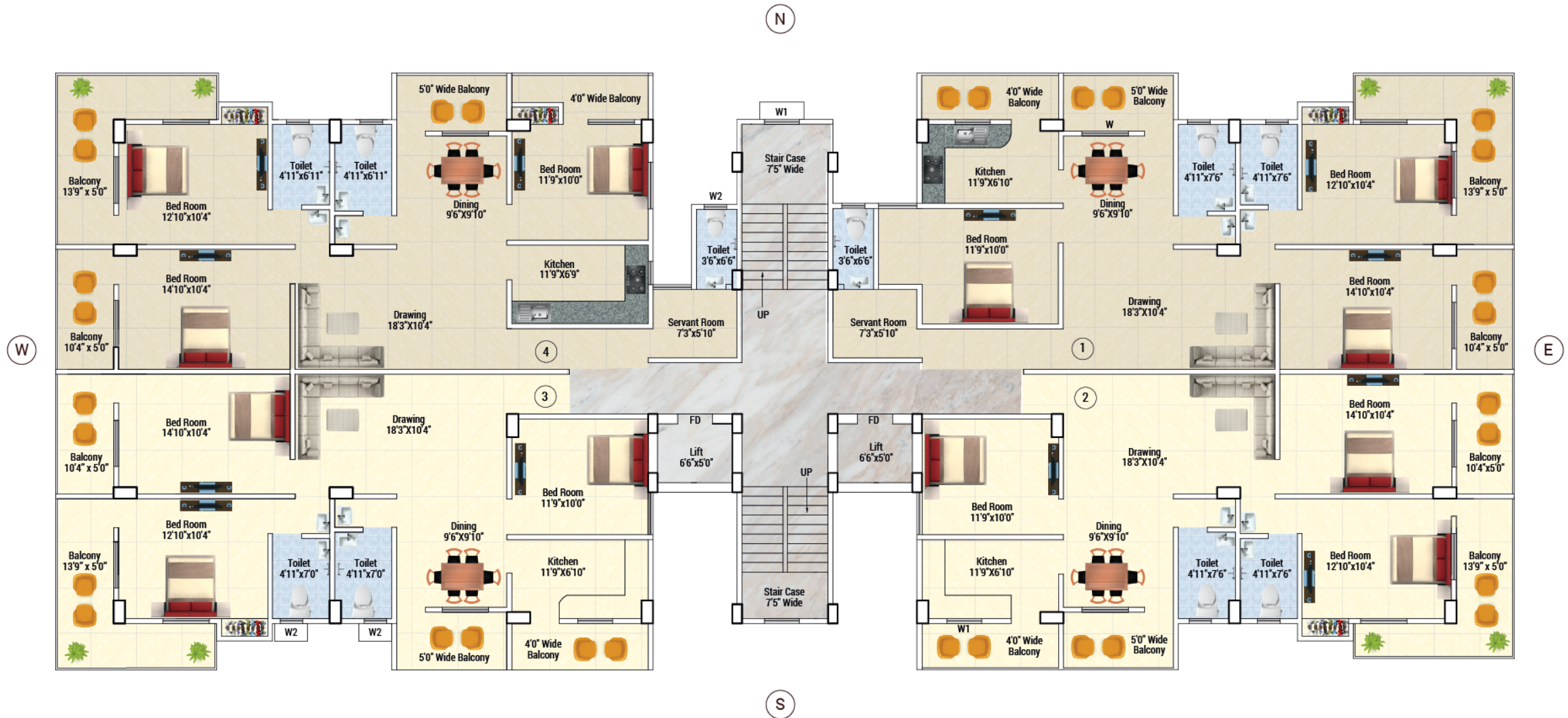

Your Dream Destination

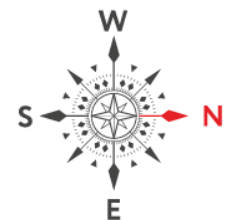



Amenities

Where lifestyle meets luxury



CCTV
(24X7 Security)



4 Lift from Basement
with Genset Backup



A.C. Banquet
Hall



Children's
Play Area



Temple



Security
Cabin



Super
Market



Seating
Area



Swimming
Pool



Car
Parking



Jogging
Track



Fire Fighting
System



Modern
Gym



Garden

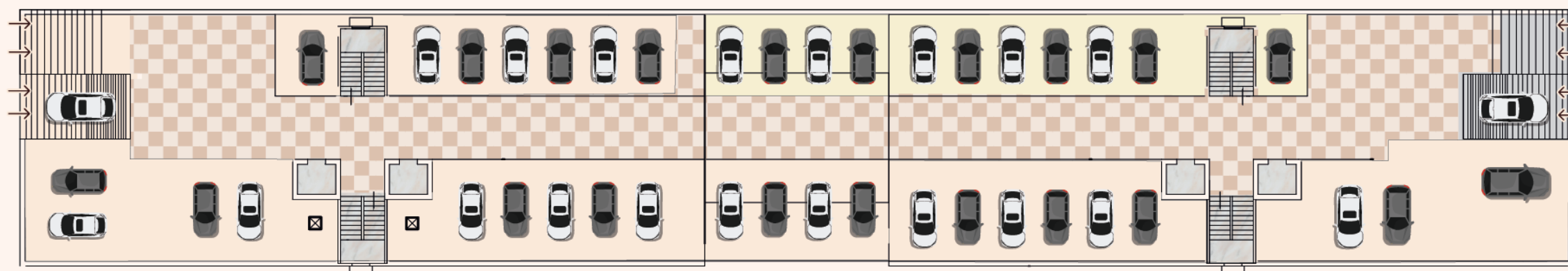

Basement Plan



Specifications

Where quality meets craftsmanship

- Structure** : RCC frame earthquake-resistant structure with walls constructed using cement mortar as per design and specifications.
- Steel** : Tata Steel / Jindal Steel
- Cement** : Ultratech / Nuvoco / ACC
- Walls** : Red Bricks / Block / Fly Ash
- Wall Finish Internal** : All internal walls will be plastered, followed by POP/Putty & a coat of white primer.
- Wall Finish External** : Classical exterior finish with exclusive design.
- Kitchen** : Granite countertop on the working platform, with 3 feet high glazed digital tiles above the platform.
- Flooring** : Vitrified Tiles Kajaria / Somany
- Doors** : Flush Door with Mica Finishing Frame - Hard Wood / Sal / Kapoor
- Window** : Wood / UPVC
- Toilet Wall** : Glazed tiles up to 7 feet on all walls.
- Sanitary Ware** : Parryware / Hindware / Jaguar
- Electricals** : Havells / Polycab / RR Kabel
- Water Supply** : 24/7 water supply from an overhead tank & deep tube well, including RO drinking water.
- Generator** : Mahindra or Kirloskar generator with sufficient capacity to provide up to 500 watts of emergency power per flat.
- Stilt Area** : Kota stone or marble flooring in the parking area.
- Intercom & TV Points** : Provided in the drawing/dining room.
- Other Facilities** : Electric, water supply, and drainage point for a washing machine.
- Lift** : OTIS / KONE / Mitsubishi (High Speed Big Size)

Payment Schedule

1.	At the time of Booking	10%
2.	Ground Floor Roof Casting	20%
3.	First Floor Roof Casting	10%
4.	Second Floor Roof Casting	10%
5.	Third Floor Roof Casting	10%
6.	Fourth Floor Roof Casting	10%
7.	Fifth Floor Roof Casting	10%
8.	Sixth Floor Roof Casting	10%
9.	20 Days before Possession	10%

Note: Government Tax/Levy extra as applicable to be paid before possession.

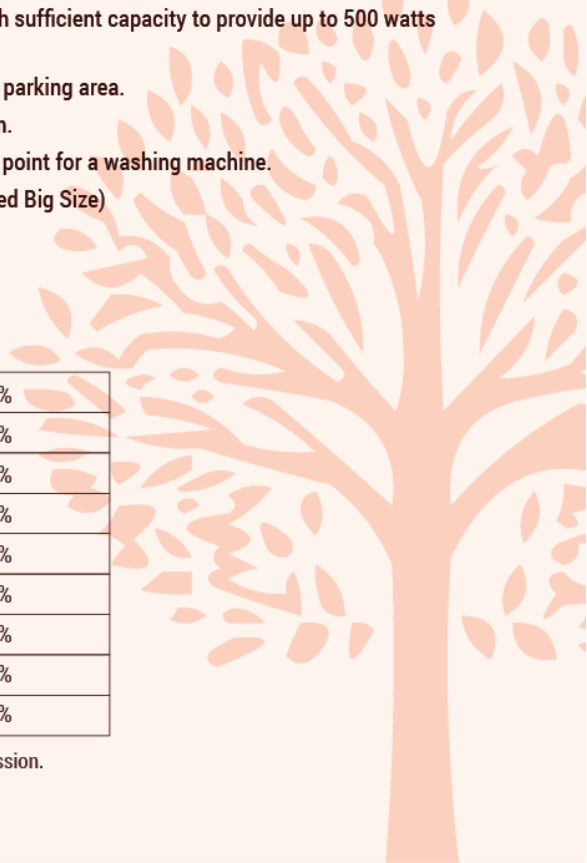

Landmarks

 **1 Km**
Saguna More
Metro Station

 **3 Km**
Danapur
Railway Station

 **10 Min**
AIIMS, Patna

 **15 Min**
Patliputra
Railway Station

 **15 Min**
Patna Airport

 **20 Min**
International
Airport, Bihta

Location Map

Not to Scale



Registered Office:
37, Raghuvansh Apartment,
Shastri Nagar, Patna - 800023 (Bihar)

 www.meenakshiconstruction.com

For Booking Contact:

 **91173 36569**

 sales@meenakshiconstruction.com

RERA Approved Project

RERA No. BRERAP12343-001/82/R-1590/2023

RERA Website : <http://nagarseva.bihar.gov.in/rerabihar>

Site Office: Opp. G.D. Goenka School, RK Puram, Danapur Khagaul Road, Near Saguna More, Patna Bihar- 801503

Disclaimer: In the quest of excellence, some of the specifications may have to be revised, specifications are subject to change in keeping high quality standard as decided by area competent authority/ Architect.